

## 1. GENERAL INFORMATION

### 1.1 Scope of this leaflet

Congratulations on your purchase of a Sturmey-Archer hub. For the best performance, please follow the instructions in this leaflet. Please contact your dealer if any problems are experienced with this product.

This leaflet refers to the following S1C single speed coaster hub

### 1.2 Lubrication

No routine lubrication is required. During a major service, the hub greases should be replenished or replaced especially for transmission parts. Please contact your Sturmey-Archer dealer who is equipped to carry this out.

### 1.3 Brake Operation

The coaster brake is activated by back-pedaling. To apply maximum braking effort, begin brake application when the pedal cranks are horizontal. When descending down a long steep slope it is advisable to apply front and rear brakes alternately to prevent the coaster brake from overheating.

## 2. INSTALLATION

1. Build the hub into a complete wheel.
2. Fit the sprocket (1) and circlip (2) onto the driver.

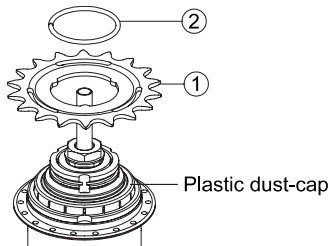

3. Put the hub axle into the rear fork end and place the chain around the sprocket.
4. Fit the dome nut (5) on the left side of the axle. **Screw the nut finger tight.**
5. Fit brake arm into brake arm clip (6) with nut (6A) and bolt (6B). **Do not tighten at this point.**

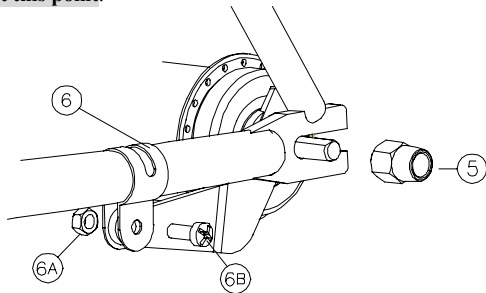

6. Locate the right-side dome nut (5). **Do not tighten nuts at this point.**

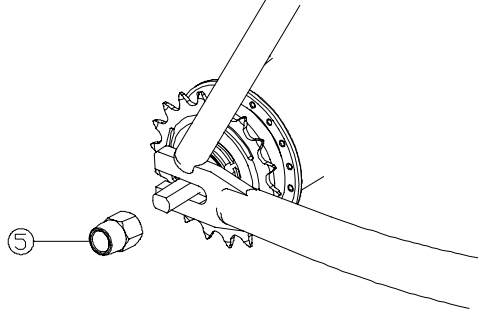

7. Align the wheel and tension the chain. Ensure that the brake arm is parallel with the chainstay.
8. Tighten both dome nuts to **28Nm** and the brake arm clip (7) nut to **7Nm**.